

Technical Specifications of the Capitol Theater

Corrections and Additions

1. A lineset chart is now included.
2. Our grid height is 50'-0".
3. We have 8,160 lbs of weight
4. Battens are 100 lbs empty. They are 2" OD pipe.
5. The Roscoe Marley is 5'-3".
6. The distance from the balcony rail to the proscenium is 67'-0". It is 17'-0" to the theater floor.
7. We own 20 music stands and 12 music stand lights.
8. We have a battery operated 24'-0" Genie lift.
9. The FOH mix is underneath the balcony overhang in the back of the theatre, house right, in front of the light booth.

Soft Goods

1. The main drape is on a traveler and is rigged to fly.
2. There is a fire curtain in front of the grand valance on its' own independent counterweight system.
3. The following are Veltex, and are sewn flat. They are all black.
 - a) 2 Sets Of Legs 10'-0" by 24'-0"
 - b) 2 Full Stage Travelers 40'-0" by 25'-0"
 - c) 3 Sets Of Borders 57'-0" by 8'-0"
 - d) 1 Set Of Tormentors 15'-0" by 26'-0"
 - e) Blackout Drop 38'-0" by 25'-0"
 - f) Rear Curtain 40'-0" by 25'-0"
4. The Cyclorama is a white seamless lino sky drop - 38'-0" by 28'-0"
5. With the exceptions of the grand valance, main drape and the two sets of dead hung legs (battens #1, #2, #13 and #20), any of the soft goods cannot be moved or removed.

Electrics

1. Number Of Dimmers: One (1) per circuit (Strand Century CD80 System)
2. Number Of Circuits: 156
3. Type Of Dimmer: SCR
4. Capacity Of Each Dimmer / Circuit: 2,400 watts
5. Number Of Non-Dim Circuits: Unlimited (Set In Soft Patch)
6. Control System: ETC Insight 3
7. Number Of Cues Available: 600
8. Any or all dimmers can be set up in submasters. 108 submasters are available, all programmable.
9. The system uses Century three-pin stage plugs.
10. Circuit Locations: See next page.

11. Electric Battens:

- a) First Electric: Batten #3
- b) Second Electric: Batten #8
- c) Third Electric: Batten #14
- d) Fourth Electric: Batten #19

With the exception of the first electric (which is permanent), the aforementioned list denotes usual locations of electrics. Drop box layout is noted on the next page.

12. Available Power Disconnect: Three-phase, 400A/leg. Box located stage right of the loading door on the upstage wall.

Circuiting Information

- 1. The front-of-house (FOH) lighting position has 24 circuits across the catwalk numbered 1 through 24 from stage left (SL) to stage right (SR). There are 10 circuits on each side slot position (directly below the FOH position). They are numbered 25 through 34 on SL, and 35 through 44 on SR.
- 2. The first electric is hard-wired with 30 circuits numbered 45 through 74 from SL to SR.
- 3. Three wall-mounted boxes with four circuits each give dimming capability at stage level:
 - a. SL proscenium wall: circuits 75 through 78.
 - b. SR proscenium wall: circuits 79 through 82.
 - c. UC wall: circuits 153 through 156.
 - d. UC wall: circuits 153 through 156.
- 4. Circuits 83 through 146 are in 16 drop boxes which power all electrics save the first electric. The boxes drop from the grid in a four by four (4 x 4) pattern, with four circuits per box. The usual placement of electrics is noted on Plan View #2, and is best-suited to the usual masking. Several light trees are available, but are discouraged due to the lack of ample wing space.
- 5. Circuits 150 through 152 are not used.

Note: If you are designing a plot for this theatre, please do not assign circuit numbers. Your plot will be pre-hung using the most available circuit and soft-patched to your dimmer notations.

We own two (2) Lycian 1209 spotlights which for the most part live in the balcony off left and right.

Lineset Chart

1	Valence	1'-0"	
2	Main	1'-6"	Drop / Travel
3	Electric 1	3'-0"	
4	Scrim	4'-6"	
5	Spare	5'-9"	
6	Tormentor	6'-6"	
7	Border 1	8'-0"	
8	Electric 2	9'-6"	
9	Inter Curtain	10'-6"	Drop / Travel
10	Spare	12'-3"	
11	Border	13'-9"	
12	Spare	14'-6"	
13	Legs	15'-6"	Dead Hung
14	Electric 3	16'-6"	
15	Spare	17'-3"	
16	Traveler	18'-3"	Dead Hung
17	Border	19'-3"	
18	Spare	20'-6"	
19	Electric 4	22'-0"	
20	Legs	23'-6"	Dead Hung
21	Spare	25'-0"	
22	Rear Curtain	26'-6"	Drop
23	Cyclorama	27'-6"	

Stage

(Refer to Plan Views #1, #2 and #3) *Dimensions listed supercede plan views*

Dimensions

1. Width of proscenium opening: 29'-3"
2. Height of proscenium opening: 20'-0"
3. Distance from downstage lip center to back wall:
 - a. with pit cover: 45'-3"
 - b. without pit cover: 35'-11"
4. Distance from downstage lip center to last upstage batten:
 - a. with pit cover: 38'-0"
 - b. without pit cover: 28'-8"
5. Distance from curtain line to back wall: 33'-6"
6. Distance from curtain line to last upstage batten: 26'
7. Distance from the last upstage batten to the back wall: 7'-3"

The back wall is not smooth. The minimum distance to the back wall is 1'-0", and the minimum distance to the upstage left wall is 0'-6". See Plan View #1. If the cyclorama is used, upstage crosses are not possible. Actors must go downstairs, through the greenroom, and back up the stairs to the opposite side of the stage.

8. Width from onstage left proscenium edge to offstage left theatre wall: 9'-3"

9. Width from onstage right proscenium edge to offstage right obstruction: 6'-8". The obstruction is the locking rail for the counterweight system.
10. Width of the orchestra pit cover: 23'-2" – See Plan View #1.

Floor

11. The stage floor is softwood tongue and groove, three layers, painted black.
12. The stage is pretty smooth: however some companies may prefer a vinyl or linoleum covering. The Capitol owns a Roscoe Marley dance floor that is gray on one side and black on the other.

Orchestra Pit/NA

13. The orchestra pit is accessible, covered or uncovered from the green room via a half height 30" door.

Loading and Unloading

14. The loading door is on the upstage wall, left of center. We load directly onto the stage.
15. The loading door opening size is 6'-0" wide by 9'-7" tall
16. The loading dock is 3'-7" above ground level.
17. We own a dock plate. 36" by 48" and a 16' x 36" 4000lbs cap ramp

Dressing Rooms

18. There are two dressing rooms:
 - a. Women's – Nine (9) lit makeup mirrors.
 - b. Women's – Nine (9) lit makeup mirrors.
19. There are sinks, showers, hot and cold running water and toilets in each. Three toilet stalls in the women's.
20. There are sinks, showers and both hot and cold running water each.
21. There is hanging space for clothing and costumes in each.
22. Greenroom and dressing rooms are equipped with stage and paging capabilities.

Counterweight System

1. The stage is equipped with a straight lift. T-bar, single purchase counterweight system.
2. Grid height: 48'-0"
3. Total number of battens: 23
4. (20 linesets and 3 dead-hung battens)
5. Length of battens: 38'-0"
6. Diameter of battens: 1"
7. The house grand drape, batten #2, will fly out until the bottom of the drape is 19' above the stage and 1' below the proscenium arch.
8. All of the battens will fly out to 48'-0". These battens have 7'-0" arbors.
9. The locking rail is located on the floor stage right.
10. There is adequate counterweight to handle almost any situation.
11. The first electric is batten #3.

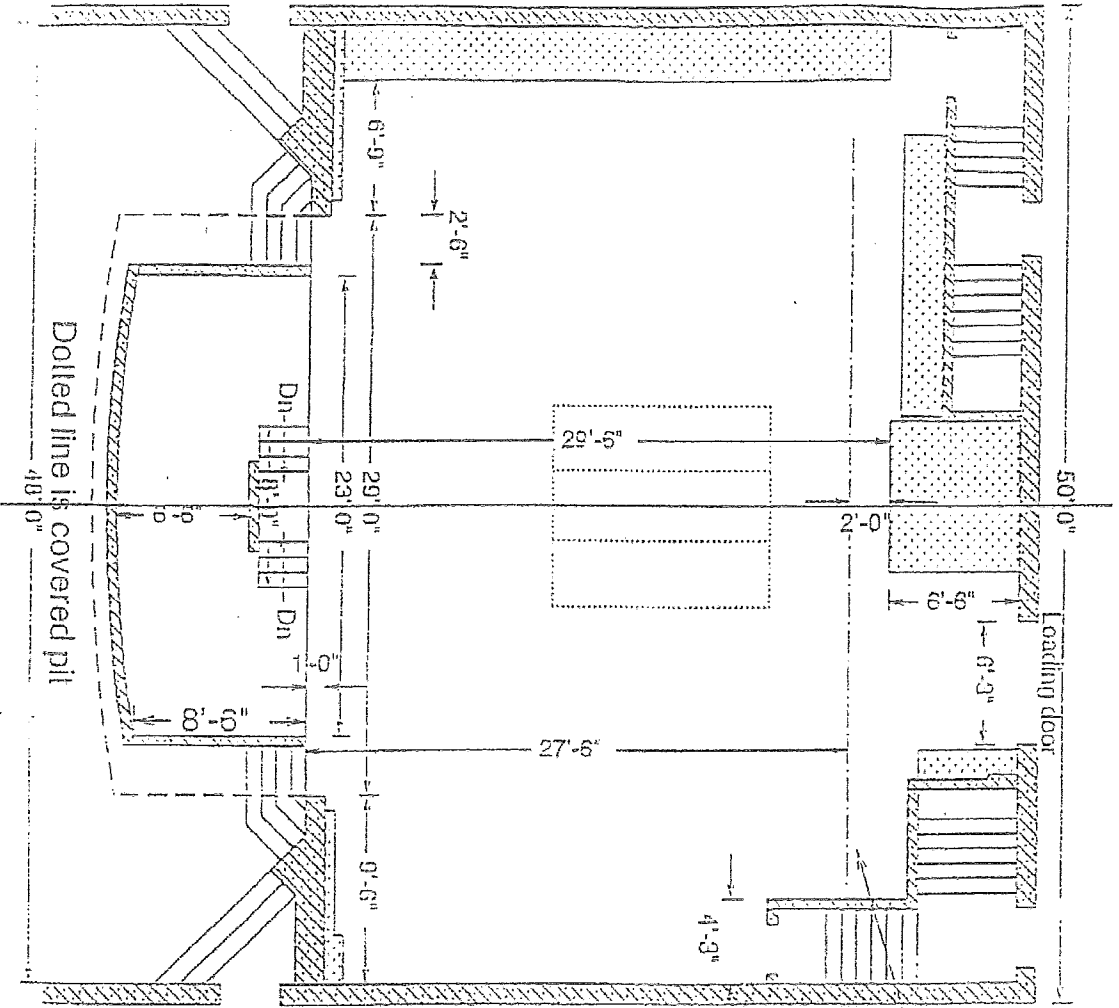

Last upstage batten

Dotted areas are obstructed

SR is the pin rail -

2' 9" out from wall at floor

4' 9" out from wall at 8' up

Up Center is piano storage

Up Right Wall is storage cabinets

Capitol Arts Center

Revised December, 1995

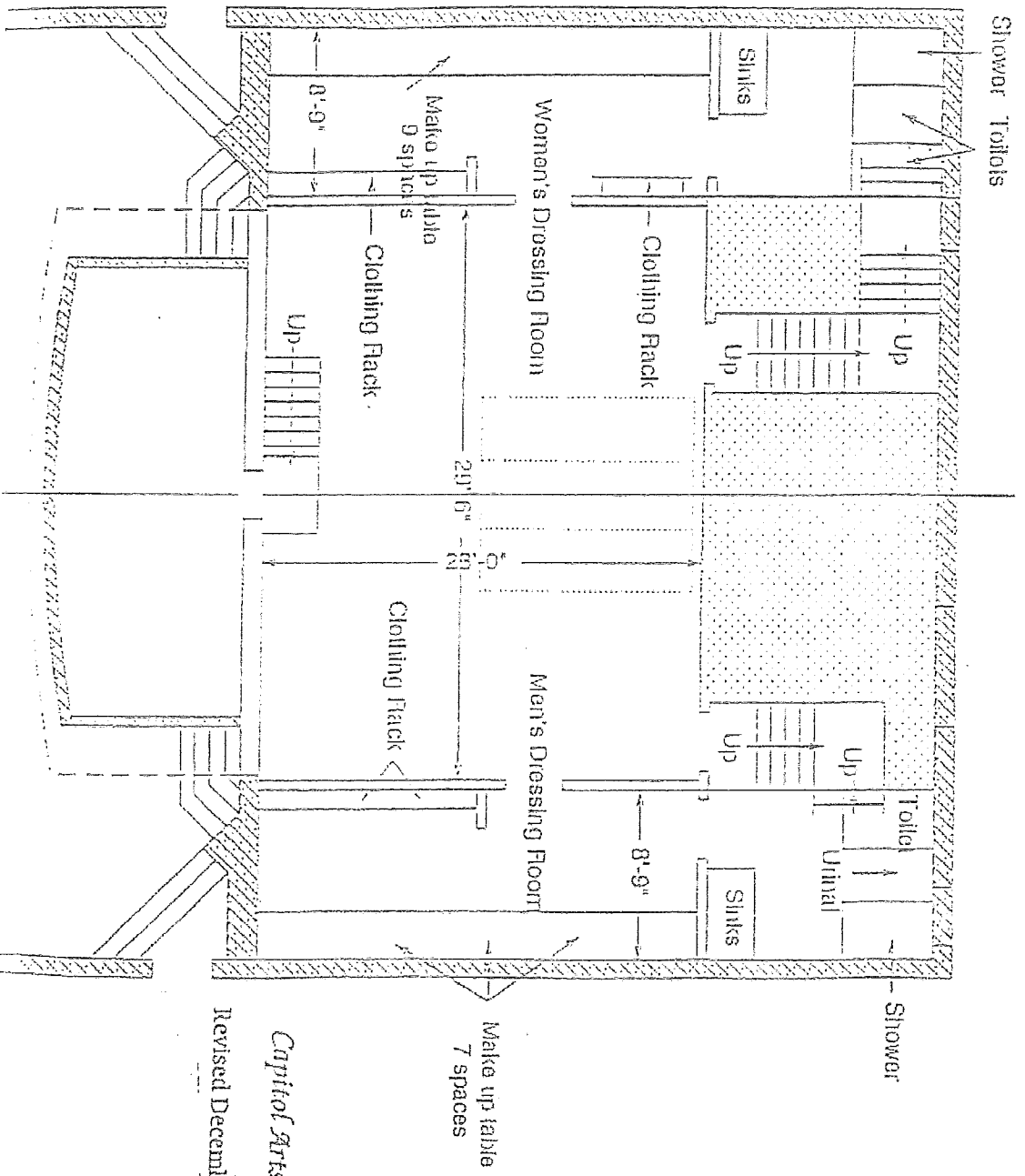

CAPITOL ARTS SOUND SYSTEM

Stereo Mains -4-3way JBL loaded speaker cabinets-2 boxes a side-Per box - 4-15" E140,2-2441/4-2404

Subs/Front Fills-4 JBL -3way Speakers-4-18"-2440/4-12"E120/4-2445..Across front of stage

Stereo Catwalk-2 JBL 4023 with 2"/2441 JBL drivers/JBL 2385 horns

Subs-Sides-2 Cerwin Vega cabinets loaded with JBL 18'/2440 speakers

2-QSC self-powered 18" subs

Under Balcony/Balcony Delays - 8-JBL control 1's

SYSTEM PROCESSING&S

2-TC 1128-EQ L&R Mains

1-TC 1280-DDL L&R Mains

5-Klark 716 Delays

3-JBL 5235 X-O Mains/Subs/Fills

4-Lab Gruppen Amps Mains

2-Crest V-1500 low & mid sub/fills

1-JBL/Urei 6260 HI's sub/fills

2-White 4000-EQ Catwalk Balcony Delays

1-Rane AD22B -DDL Catwalk Balcony Delays

1-JBL 5235 X-O Catwalk Balcony Delays

1-Yamaha 2201-Catwalk low

1-Crown D-150-Catwalk hi

1-White 4103-EQ Balcony & Under Balcony delays

1-White 4500 EQ subs/Qsc's

1-TC 1389 DDL/Under Balcony & Front Fills

1-Yamaha 2201 patchable/Onstage Monitors

3-Yamaha 2050/1-patchable/EFXs/surrounds /additional delays

FOH CONSOLES & PROCESSING

Yamaha PM 4000 -52 FOH
Yamaha PM-1600-16 MON
2-TC 1128 EQ Patchable
1-Roland SDE-1000 DDL
1-Lexicon MPX-100 Multi EFX
4-Urei LA-12 Comp/Limiters
1-Aphex 106 4-channel comp
1-Sony MDS-JE520 mini disc player/rec
1-Toshiba SD-3960 DVD player
1-RCA RP8078 5 disc cd changer
1-Sony 7506 headphones

MONITORS & PROCESSING

4-EAW SM155Hi passive wedges
1-JBL 4623 drum/keyboard 15"
2-JBL 4602 passive wedges 12"/bullet
2-JBL 4604 Passive wedges 15'/1"flat front bi-radial
2-JBL 4870 side fills/2way active Double 15" w/2445
8-Yamaha Q2031/monitor rack
2-Yamaha PD2500/for EAW's
1-Crown PSA-2/side fills low
2-JBL/Urei 6260/side fills high & drum Mon
1-70 volt backstage system/with page and program
1-Anchor AN-100
4-QSC HPR 122i/self-powered 2 ways

MIRCOPHONES & DI'S

1-EV RE-20 3-Countryman FET85 active DI
3-EV-468 3-Crown PZM 1-BSS AR16 active DI
8-Shure SM 58 4-Crown PCC166 3-Rapco passive DI
8-Shure SM 57 1-Shure SM 565 1-Cducer 2-6" tapes
1-Audix PV 4-Whirlwind passive DI 4-AKG 170
7-Audio Tech ATM11R 2-Sony 7604 Headphones
1- Sennheiser EM 2003 w/body pack and MKE-2

MICROPHONE STANDS AND CABLES

Whirlwind Concert 56 transformer ISO splitter/with breakouts/ 56 mic lines/8 returns to FOH

12-Tall straight

4 tall tripods

4 small tripods

12-booms

Assorted XLR microphone cables and adaptors

